

## INSTRUCTIONS FOR USE AND MAINTENANCE

# STIFFLINE THROWLINE

LENGTH			
FIRST DATE OF USE			
DATE OF PURCHASE			
REF. STIFFLINE YELLOW	DIAMETER	1.8 mm	FTC/FDJ 18
REF. STIFFLINE BLUE	DIAMETER	1.8 mm	FTC/FDB 18
REF. STIFFLINE YELLOW	DIAMETER	1.6 mm	FTC/FDJ 16
REF. STIFFLINE GREEN	DIAMETER	1.6 mm	FTC/FDV 16

JULY 2017 VERSION (TRANSLATED)



1355, chemin de Malombre • Z.I. Les Plaines  
26780 MALATAVERNE • FRANCE • (+33) 475 528 640  
[contact@ftc-tree.com](mailto:contact@ftc-tree.com) • [www.ftc-tree.com](http://www.ftc-tree.com)

## 1 TECHNICAL DATA

Diameter	1.6 mm	1.8 mm
Minimum	220 daN*	250 daN*
Weight per	1.58 g	1.92 g
Weight for 50 m	80 g	96 g
Materials	Dyneema cover, polypropylene core	

Length: with coloured ends, 40 cm without core, breaking fuse point 16 cm from each end (about 80 daN).

\*1 daN (dekanewton, a measure of force) is equal to 1 kg.

## 2 USE



**THIS MATERIAL IS NOT PPE. UNDER NO CIRCUMSTANCES SHOULD IT BE USED FOR BELAYING.**

- The STIFFLINE is used for throwing bags in tree care.
- It is used to set up ropes (access, climbing and rigging ropes), cambium saver etc.
- Its solidness and reliability allow many technical tricks: retrieving cambium savers, breaking ddead branches from the ground, lifting gear into the tree etc.

### THIS EQUIPMENT MUST BE USED:

- By trained and/or competent people.
- After verifying its condition and functioning.
- In full respect of the manufacturer's instructions.
- With equipment having the same size and resistance properties.
- **With gloves to avoid burns and cuts.**



**FTC CANNOT BE HELD RESPONSIBLE FOR ANY DIRECT, INDIRECT, OR ACCIDENTAL CONSEQUENCES OR ANY OTHER TYPE OF DAMAGE THAT ARISES DURING USE.**



**TAKE THE NECESSARY PRECAUTIONS WHEN THROWING NEAR ELECTRIC POWER LINES.**

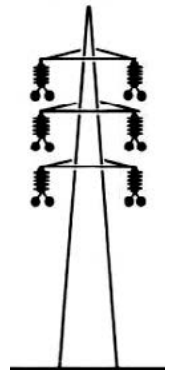

### 3 CARE / STORAGE

- Avoid putting the product in contact with heat sources and abrasive, acidic or corrosive materials that can damage it or reduce its technical performance (fuel, dirt, mud, sand etc.).
- Store it in a dry, ventilated place away from light and any heat source higher than 40°C. During use or when putting away, do not excessively twist or fold the line in order to avoid bends in the core.
- Do not make knots along the line. This damages the ease of its movement.
- Can be washed with delicate washing powder at a maximum temperature of 30°C. Air dry without exposing to the sun.
- To increase ease of movement, it can be sprayed with teflon.

#### REPAIRS AND CARE:

- Preparation of the ends if the breaking fuse point or throwline breaks.
- To make an end more flexible for tying around throwbags or ropes, cut off approximately 40 cm of the core.
- To make a breaking fuse, see chapter 4.

### 4 EXAMPLES OF USE

#### KNOTS FOR ATTACHING THROWBAGS

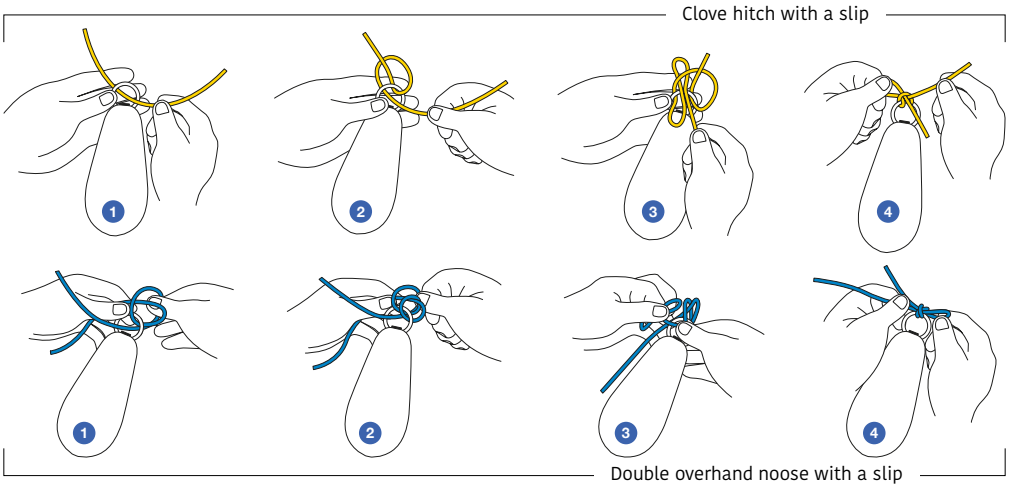

#### KNOTS FOR ATTACHING ROPES

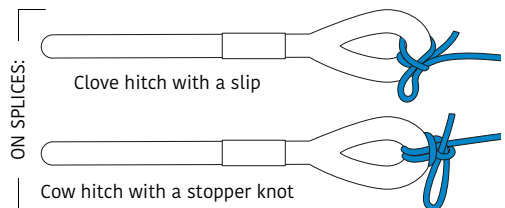
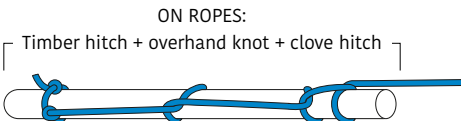

## SETTING UP CAMBIUM SAVER

Setting up cambium saver and then rope from the ground.

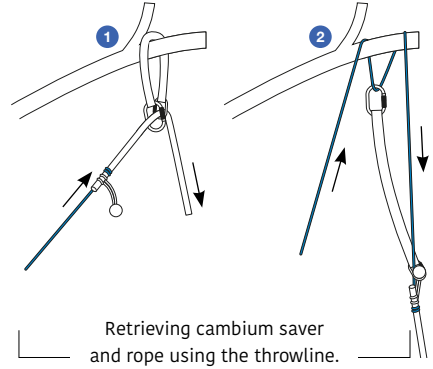
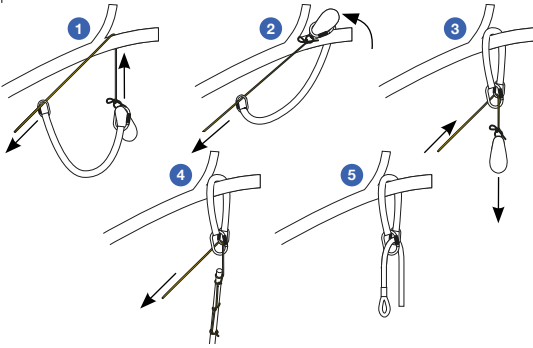

## UNHOOKING A STUCK CAMBIUM SAVER

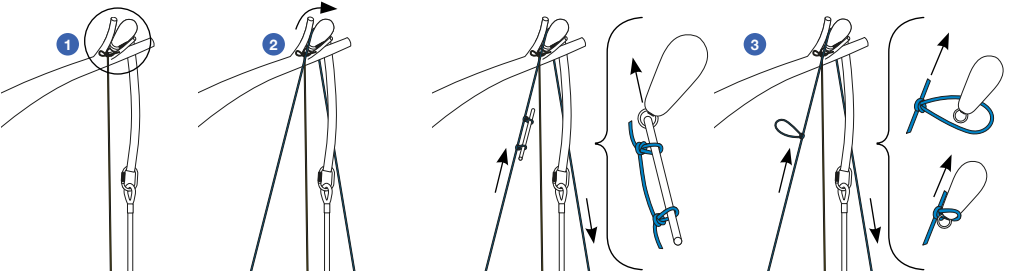

## BREAKING POINT

To make a fuse point (deliberate breaking point in case the bag is stuck), cut a bit more than half of the line approximately 16 cm from the end. Use a seam ripper or any other cutting tool (see illustration). By doing this, the line's resistance will be less than 100 kg.

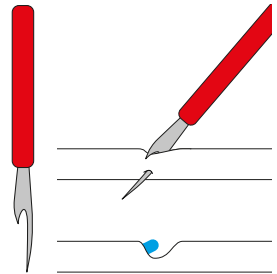

1355, chemin de Malombre • Z.I. Les Plaines  
26780 MALATAVERNE • FRANCE • (+33) 475 528 640  
[contact@ftc-tree.com](mailto:contact@ftc-tree.com) • [www.ftc-tree.com](http://www.ftc-tree.com)